

COMMERCIAL STYLE 20 FT. CONTAINER BOTTOM LIFT SLING WITH UNIVERSAL MANUAL LEVELING, WLL 30 LT (Q2500AA-299)

Cage Code: 65059 | Drawing No: SQ2500AA-299 | Revision: B | Sheet: 1 of 4

UNLESS OTHERWISE SPECIFIED, DIMENSIONS ARE IN INCHES

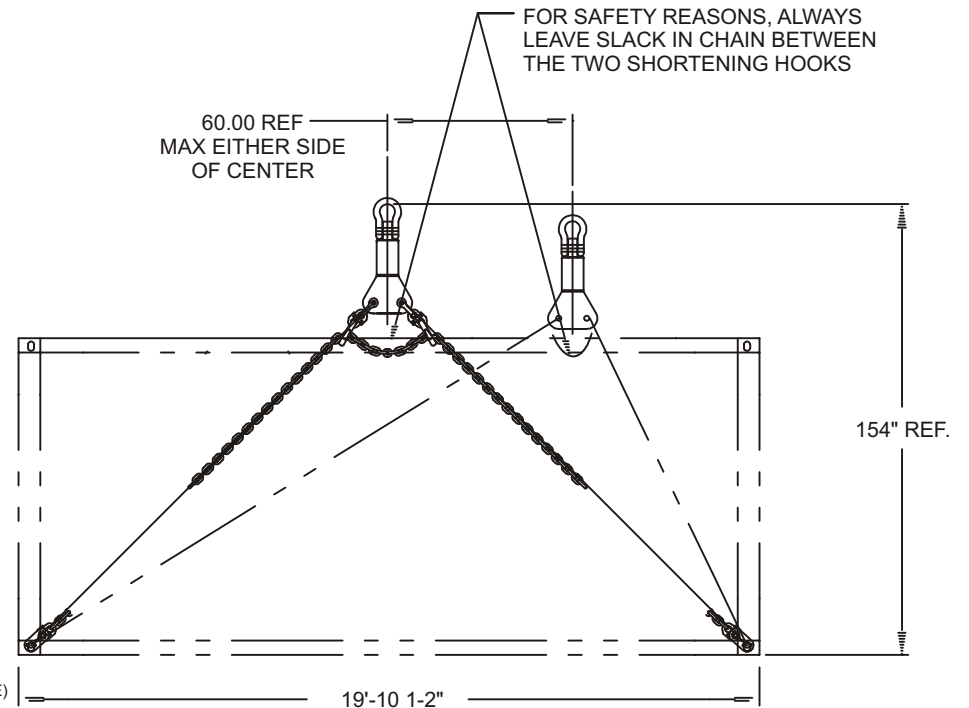
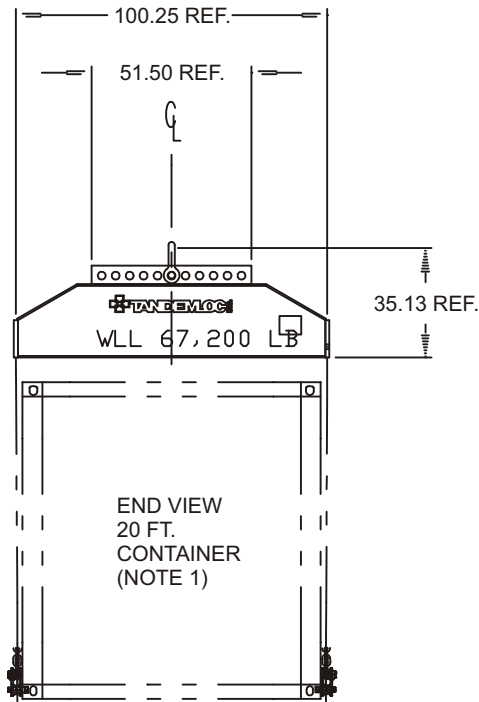

SIDE VIEW OF TYPICAL
20 FT. CONT. (NOTE 1)
ISO MAX. GROSS WEIGHT 52,900 LB.
SLING WLL IS 67,200 LB.

NOTE:

- THE CONTAINERS NOTED ON THIS DWG. ARE TYPICAL ISO FREIGHT CONTAINERS AS DESCRIBED IN ISO 668:1988(E) DESIGNATION
1CC, 1C, 1CX - ALL "20 FT" CONTAINERS (19'-10" 1/2") CONTAINERS (9'-9 3/4") AT THEIR MAX LOAD RATING.
- LOAD LEVELING OF THIS SLING IS ACCOMPLISHED BY MANUALLY MOVING THE TOP SHACKLE; IE, BY PLACING ITS BOLT INTO ONE OF THE 11 HOLES PROVIDED FOR TRANSVERSE LEVELING AND BY ADJUSTING THE CHAIN LEG LENGTHS TO LEVEL LONGITUDINALLY. KEEP THE CHAIN LENGTHS MATCHED ON EACH SIDE. CHAIN IS COLOR MARKED AT CENTER AND EVERY 10 LINKS FOUR PLACES ON EACH SIDE OF CENTER.
- THE WORK LOAD LIMIT (WLL) OF THIS SLING IS 67,200 LB.
- BEAM - PROOF TESTED TO 125% OF WORK LOAD LIMIT (WLL).
CHAIN AND FITTINGS - TESTED TO 200% OF THEIR RATED WLL.
- THIS SLING ASSEMBLY CONFORMS TO ANSI B30.9-1996, ANSI B30.19-199, B30.20 & I.S.O. 3874 FGT. CONT. HANDLING.
- MATERIAL: STEEL WITH SAFETY YELLOW PAINT.
CHAIN & CONNECTOR LINK PINS/SPACERS ARE NOT PAINTED.
- WEIGHT: 1,223 LB, 1,409 LB. WITH PC 9.
- ALL DIMENSIONS SUBJECT TO MFG TOL.
- PC 9 IS THE METAL SHIPPING CONTAINER PROVIDED WITH EACH SLING ASSEMBLY.

		REVISIONS	
REV	DESCRIPTION	DATE	APPROVED
A	REF ECO 06-044	11/28/06	WT
B	REVISED DRAWING TO SHOW HOOK DIRECTION FACES OUT	09/21/07	DAH

To avoid lifter failure, potential death and property damage, never exceed WLL (Working Load Limit)

This document contains the proprietary information of Tandemloc, Inc. and your access and use shall be, and is at all times, pursuant to and limited by the Tandemloc, Inc. Terms of Use.

You shall not, and shall not encourage, assist, or authorize another party to copy, distribute, publically display, modify, reverse engineer, decompile, or take any other action to reproduce or replicate this document or the information contained herein. © Copyright 2012 by Tandemloc, Inc.

Dimensions are subject to manufacturing tolerance and change.



Email: info@tandemloc.com • www.tandemloc.com
824 Highway 101 • Havelock, NC 28532
TEL: 1.800.258.7324 (252.447.7155)
FAX: 1.800.892.3273 (252.447.5502)

Tandemloc designs, manufactures and tests lifting, securing and mobilizing components for all industries. See our website for details and important safety information.
Read all safety labels and instructions prior to use. Product to be used by qualified personnel only.

COMMERCIAL STYLE 20 FT. CONTAINER BOTTOM LIFT SLING WITH UNIVERSAL MANUAL LEVELING, WLL 30 LT (Q2500AA-299)

Cage Code: 65059 | Drawing No: SQ2500AA-299 | Revision: B | Sheet: 2 of 4

UNLESS OTHERWISE SPECIFIED, DIMENSIONS ARE IN INCHES

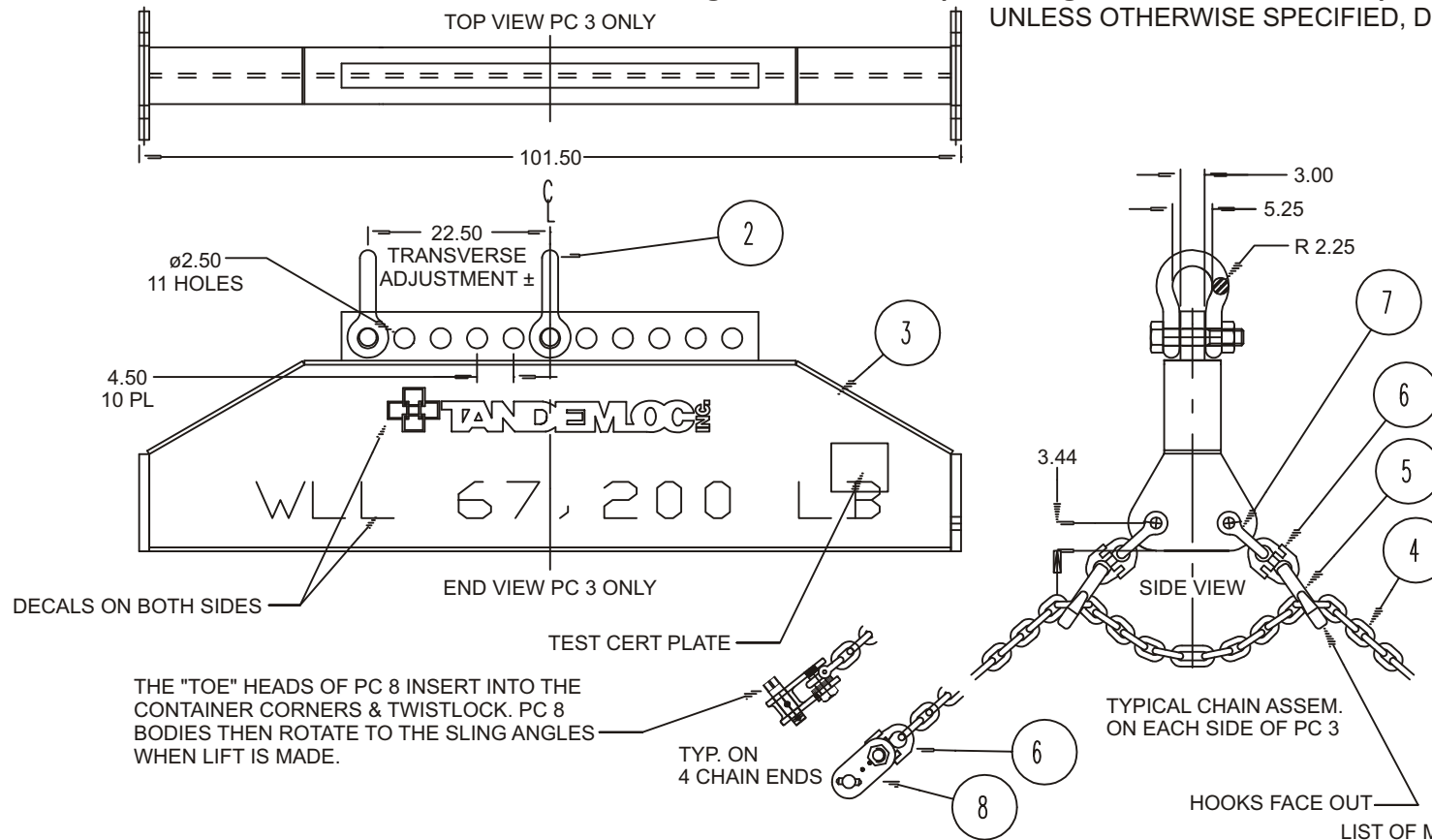

LIST OF MATERIALS

PC. NO.	QUAN	PART NO. AND DESCRIPTION
9	1	Q2500AA-B1 METAL SHIPPING CONTAINER
8	4	416000B-LTZ ROTARY LIFT LUG, T. ZINC COATED
7	4	SMALL SHACKLE W/ BOLT, NUT, COTTER, GALV.
6	8	ALLOY CHAIN CONNECTOR, PAINTED
5	4	CHAIN SHORTENER, GALV.
4	2	GR80 STL CHAIN, CUT 350" & MKD
3	1	Q2505AA-2PA LIFTBEAM ASSEMBLY, PAINTED
2	1	LARGE SHACKLE, W/ BOLT, NUT, COTTER, GALV
-	-	-
-	-	-

To avoid lifter failure, potential death and property damage, never exceed WLL (Working Load Limit)

This document contains the proprietary information of Tandemloc, Inc. and your access and use shall be, and is at all times, pursuant to and limited by the Tandemloc, Inc. Terms of Use.

You shall not, and shall not encourage, assist, or authorize another party to copy, distribute, publicly display, modify, reverse engineer, decompile, or take any other action to reproduce or replicate this document or the information contained herein. © Copyright 2012 by Tandemloc, Inc.

Dimensions are subject to manufacturing tolerance and change.



Email: info@tandemloc.com • www.tandemloc.com
824 Highway 101 • Havelock, NC 28532
TEL: 1.800.258.7324 (252.447.7155)
FAX: 1.800.892.3273 (252.447.5502)

Tandemloc designs, manufactures and tests lifting, securing and mobilizing components for all industries. See our website for details and important safety information.
Read all safety labels and instructions prior to use. Product to be used by qualified personnel only.

COMMERCIAL STYLE 40 FT./20 FT. CONTAINER BOTTOM LIFT SLING WITH UNIVERSAL MANUAL LEVELING, WLL 30 LT (Q2500AA-400C)

Cage Code: 65059 | Drawing No: SQ2500AA-400C | Revision: C | Sheet: 1 of 2

UNLESS OTHERWISE SPECIFIED, DIMENSIONS ARE IN INCHES

NOTE:

1. THE CONTAINERS NOTED ON THIS DWG. ARE TYPICAL ISO FREIGHT CONTAINERS AS DESCRIBED IN ISO 668:1988(E) DESIGNATION
 1AAA, 1AA, 1A, 1AX - ALL "40 FT" CONTAINERS
 1CC, 1C, 1CX - ALL "20 FT" CONTAINERS (19'-10" 1/2")
 THIS SLING CAN ALSO LIFT 1BB, 1B, 1BX "30 FT." CONTAINERS (29'-11 1/4") & 1D & 1DX "10 FT." CONTAINERS (9'-9 3/4") AT THEIR MAX LOAD RATING.
2. LOAD LEVELING OF THIS SLING IS ACCOMPLISHED BY MANUALLY MOVING THE TOP SHACKLE; IE, BY PLACING ITS BOLT INTO ONE OF THE 11 HOLES PROVIDED FOR TRANSVERSE LEVELING AND BY ADJUSTING THE CHAIN LEG LENGTHS TO LEVEL LONGITUDINALLY. KEEP THE CHAIN LENGTHS MATCHED ON EACH SIDE. CHAIN IS COLOR MARKED AT CENTER AND EVERY 10 LINKS FOUR PLACES ON EACH SIDE OF CENTER.
3. THE WORK LOAD LIMIT (WLL) OF THIS SLING IS 67,200 LB.
4. BEAM - PROOF TESTED TO 125% OF WORK LOAD LIMIT (WLL);
 CHAIN & FITTINGS - TESTED TO 200% OF THEIR RATED WLL
5. THIS SLING ASSEMBLY CONFORMS TO ANSI B30.9-1996, ANSI B30.19-199, B30.20 & I.S.O. 3874 FGT. CONT. HANDLING.
6. MATERIAL: STEEL WITH SAFETY YELLOW PAINT. CHAIN & CONNECTOR LINK PINS/SPACERS ARE NOT PAINTED.
7. WEIGHT: 1,534 LB, 1,720 LB. WITH PC 9.
8. ALL DIMENSIONS SUBJECT TO MFG TOL.
9. PC 9 IS THE METAL SHIPPING CONTAINER PROVIDED WITH EACH SLING ASSEMBLY.

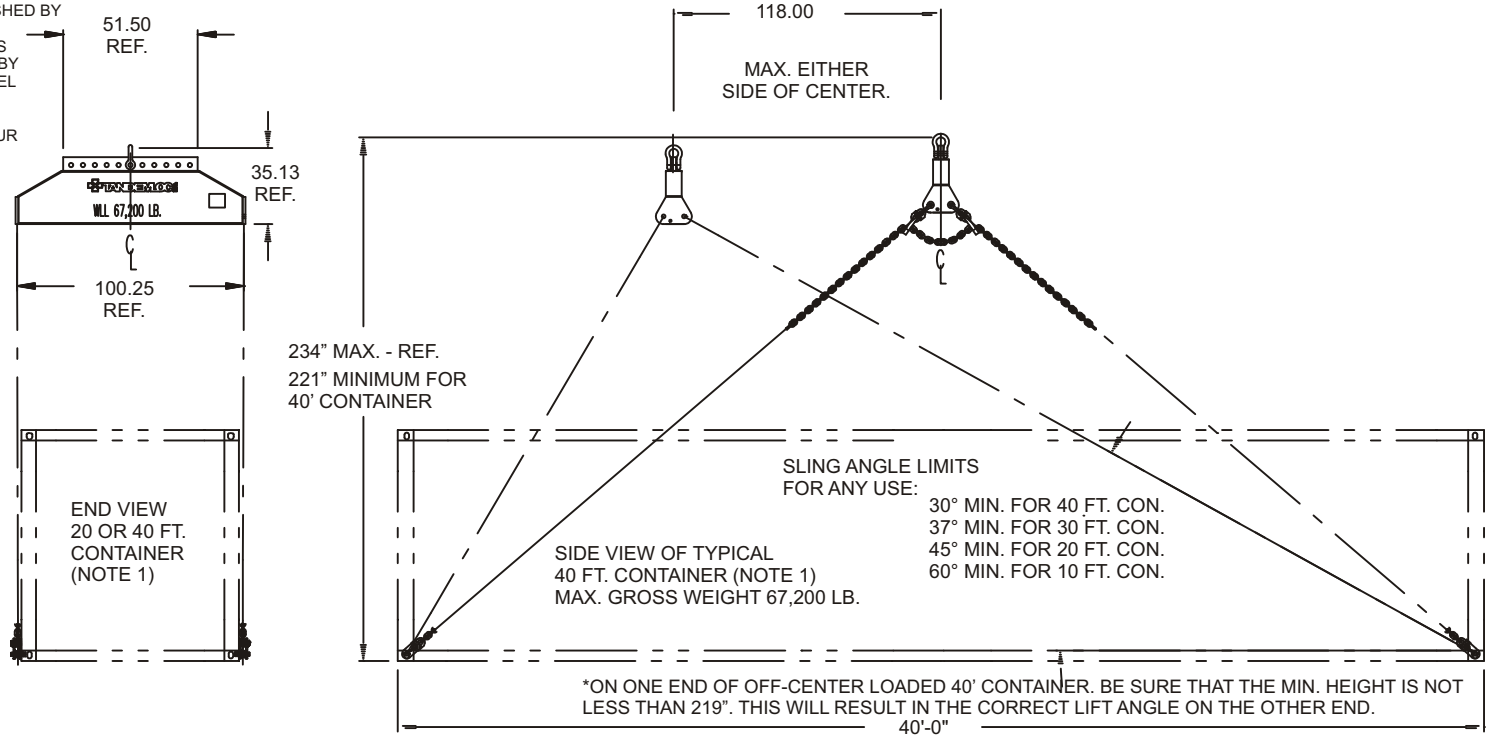

REVISIONS		DATE	APP.
REV	DESCRIPTION		
A	MIN. HEIGHT FOR 40' CONTAINER LIFT OF 219" WAS ADDED ALONG WITH ASTERISK NOTE FOR 30' LIFT ANGLE	04/04/06	MD
B	REF ECO 06-045 "A"	12/04/06	WT
C	REVISED DRAWING TO SHOW HOOK DIRECTION FACES OUT	09/20/07	WT

To avoid lifter failure, potential death and property damage, never exceed WLL (Working Load Limit)

This document contains the proprietary information of Tandemloc, Inc. and your access and use shall be, and is at all times, pursuant to and limited by the Tandemloc, Inc. Terms of Use.

You shall not, and shall not encourage, assist, or authorize another party to copy, distribute, publically display, modify, reverse engineer, decompile, or take any other action to reproduce or replicate this document or the information contained herein. © Copyright 2012 by Tandemloc, Inc.

Dimensions are subject to manufacturing tolerance and change.



Email: info@tandemloc.com • www.tandemloc.com
 824 Highway 101 • Havelock, NC 28532
 TEL: 1.800.258.7324 (252.447.7155)
 FAX: 1.800.892.3273 (252.447.5502)

Tandemloc designs, manufactures and tests lifting, securing and mobilizing components for all industries. See our website for details and important safety information.

Read all safety labels and instructions prior to use. Product to be used by qualified personnel only.

COMMERCIAL STYLE 40 FT./20 FT. CONTAINER BOTTOM LIFT SLING WITH UNIVERSAL MANUAL LEVELING, WLL 30 LT (Q2500AA-400C)

Cage Code: 65059 | Drawing No: SQ2500AA-400C | Revision: C | Sheet: 2 of 2

UNLESS OTHERWISE SPECIFIED, DIMENSIONS ARE IN INCHES

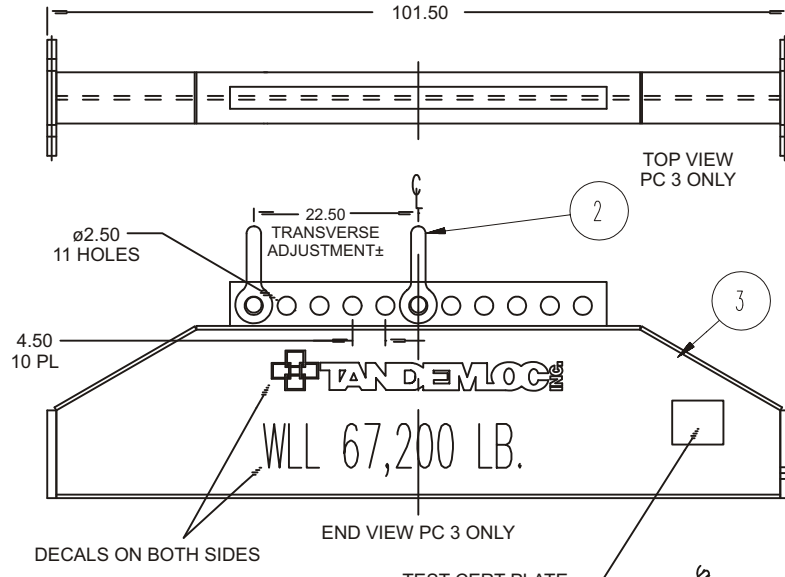

THE "TOE" HEADS OF PC 8 INSERT INTO THE CONTAINER CORNERS & TWIST LOCK. PC 8 BODIES THEN ROTATE TO THE SLING ANGLES WHEN LIFT IS MADE.

TYP. ON 4 CHAIN ENDS

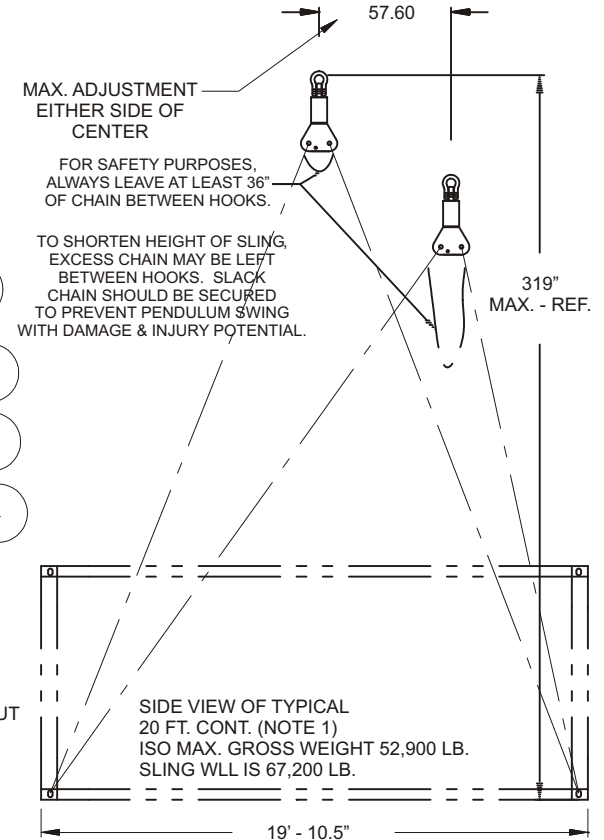
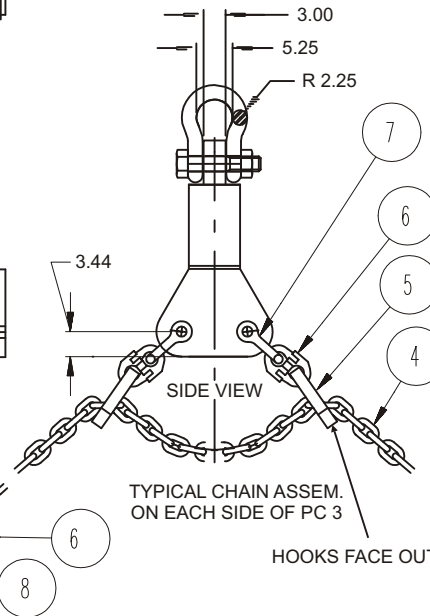

LIST OF MATERIALS

PC. NO.	QUAN	DESCRIPTION
9	1	Q2500AA-B1 METAL SHIPPING CONTAINER
8	4	416000B-LTZ ROTARY LIFT LUG, THERM. ZN COATED
7	4	SMALL SHACKLE W/ BOLT, NUT, COTTER, GALV.
6	8	ALLOY CHAIN CONNECTOR, PAINTED
5	4	CHAIN SHORTENER, GALV
4	2	GR80 STL CHAIN, CUT 600"±4" LG & MKD
3	1	Q2505AA-2PA LIFT BEAM ASSEMBLY
2	1	LARGE SHACKLE, W/ BOLT, NUT, COTTER, GALV
-	-	-
PC. NO.	QUAN	DESCRIPTION

REV	DESCRIPTION	REVISIONS	DATE	APP.
A	MIN. HEIGHT FOR 40' CONTAINER LIFT OF 219" WAS ADDED ALONG WITH ASTERISK NOTE FOR 30' LIFT ANGLE		04/04/06	MD
B	REF ECO 06-045 "A"		12/04/06	WT
C	REVISED DRAWING TO SHOW HOOK DIRECTION FACES OUT		09/20/07	WT

To avoid lifter failure, potential death and property damage, never exceed WLL (Working Load Limit)

This document contains the proprietary information of Tandemloc, Inc. and your access and use shall be, and is at all times, pursuant to and limited by the Tandemloc, Inc. Terms of Use.

You shall not, and shall not encourage, assist, or authorize another party to copy, distribute, publically display, modify, reverse engineer, decompile, or take any other action to reproduce or replicate this document or the information contained herein. © Copyright 2012 by Tandemloc, Inc.

Dimensions are subject to manufacturing tolerance and change.



Email: info@tandemloc.com • www.tandemloc.com
824 Highway 101 • Havelock, NC 28532
TEL: 1.800.258.7324 (252.447.7155)
FAX: 1.800.892.3273 (252.447.5502)

Tandemloc designs, manufactures and tests lifting, securing and mobilizing components for all industries. See our website for details and important safety information.
Read all safety labels and instructions prior to use. Product to be used by qualified personnel only.