

UNIVERSAL BRIDGE CLAMP FOR MOBILE FACILITIES (P0500AC-1PZ)

Cage Code: 65059 | Drawing No: SP0500AC | Revision: E | Sheet: 1 of 1

UNLESS OTHERWISE SPECIFIED, DIMENSIONS ARE IN INCHES

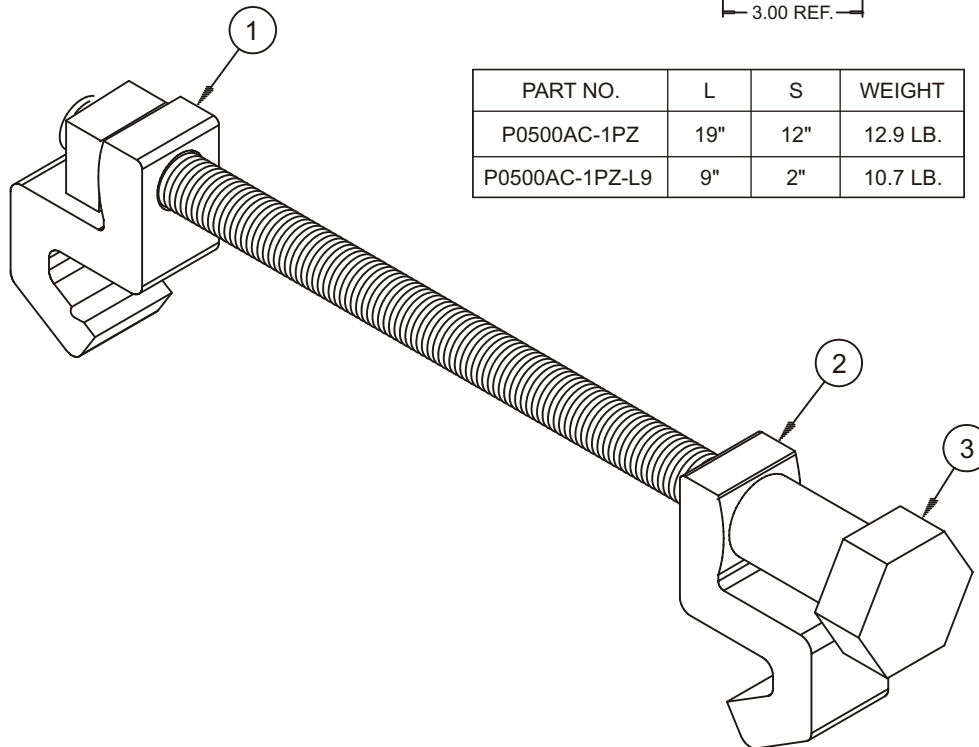
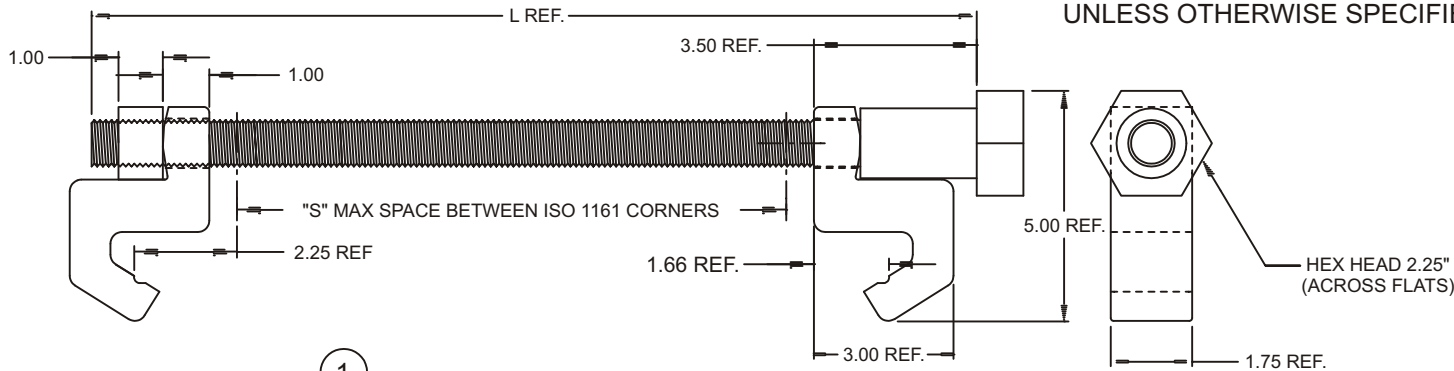

PART NO.	L	S	WEIGHT
P0500AC-1PZ	19"	12"	12.9 LB.
P0500AC-1PZ-L9	9"	2"	10.7 LB.

NOTES:

- P/N: P0500AC-1PZ UNIVERSAL BRIDGE CLAMP (L=19")
P/N: P0500AC-1PZ-L9 UNIVERSAL BRIDGE CLAMP (L=9")
- FOR CLAMPING ANY APERTURE OF TOP OR BOTTOM ISO 1161 CORNER FITTINGS UP TO "S" INCHES APART.
- TO OPERATE, ADJUST SPAN OF ITEM 1 TO PRESENT SPAN BETWEEN CORNER FITTINGS BY TURNING ITEM 3 COUNTER-CLOCKWISE TO LENGTHEN AND CLOCKWISE TO SHORTEN. PLACE ITEMS 1 AND 2 INTO THE DESIRED APERTURES OF THE CORNER FITTINGS. TURN HEX ON ITEM 3 USING A 2.25" DRIVE UNTIL CONTAINERS ARE AT DESIRED SPACING.
- MAX SAFE WORK LOAD WITHOUT YIELD: 200 FT LBS OF TORQUE (20,000 LBS TENSION) WHEN ENGAGED TO THE RIGIDLY AFFIXED CORNERS OF ISO FREIGHT CONTAINERS.

REV	DESCRIPTION	REVISIONS	DATE	APPROVED
A	ADDED 2D DWG & DIM DATA.		5/1/98	MD
B	ADDED WEIGHT		5/1/98	MD
C	LOAD RATING WAS "SWL: 200 FT. LB. OF TORQUE 20,000 LB TENSION"		10/19/07	MD
D	ADDED -1ZN-L9 PART WITH DATA		11/13/07	MD
E	-1PZ & -1PZ-L9 WAS SHOWN AS -1ZN & -1ZN-L9 RESPECTIVELY IN 3 PLACES		01/15/08	WT

To avoid lifter failure, potential death and property damage, never exceed WLL (Working Load Limit)

This document contains the proprietary information of Tandemloc, Inc. and your access and use shall be, and is at all times, pursuant to and limited by the Tandemloc, Inc. Terms of Use.

You shall not, and shall not encourage, assist, or authorize another party to copy, distribute, publically display, modify, reverse engineer, decompile, or take any other action to reproduce or replicate this document or the information contained herein. © Copyright 2012 by Tandemloc, Inc.

Dimensions are subject to manufacturing tolerance and change.



Email: info@tandemloc.com • www.tandemloc.com
824 Highway 101 • Havelock, NC 28532
TEL: 1.800.258.7324 (252.447.7155)
FAX: 1.800.892.3273 (252.447.5502)

Tandemloc designs, manufactures and tests lifting, securing and mobilizing components for all industries. See our website for details and important safety information.

Read all safety labels and instructions prior to use. Product to be used by qualified personnel only.