

20' FORKLIFT SPREADER (AC37000A-1PA)

Cage Code: 65059 | Drawing No: SAC37000A | Revision: C | Sheet: 1 of 3

UNLESS OTHERWISE SPECIFIED, DIMENSIONS ARE IN INCHES
SEE ELECTRONIC PARTS LIST FOR BILL OF MATERIALS

NOTES:

1. P/N: AC37000A-1PA, FORKLIFT SPREADER, 20', WITH 4 LEG 45° SLING (NOT SHOWN)
2. WLL: 52,900 LB (24 MT)
3. PROOF TESTED TO 125% (66,125 LB) AND CERTIFIED ON TWO TESTS (FROM FORK POCKETS AND CORNERS.)
4. FOR STANDARD 20' ISO FREIGHT CONTAINERS WITH ISO 1161 CORNER FITTINGS
5. CALCULATED WEIGHT: 4,300 LB (INCLUDES SLING, NOT SHOWN)
6. FINISH: SANDBLAST, PRIME AND PAINT SAFETY YELLOW

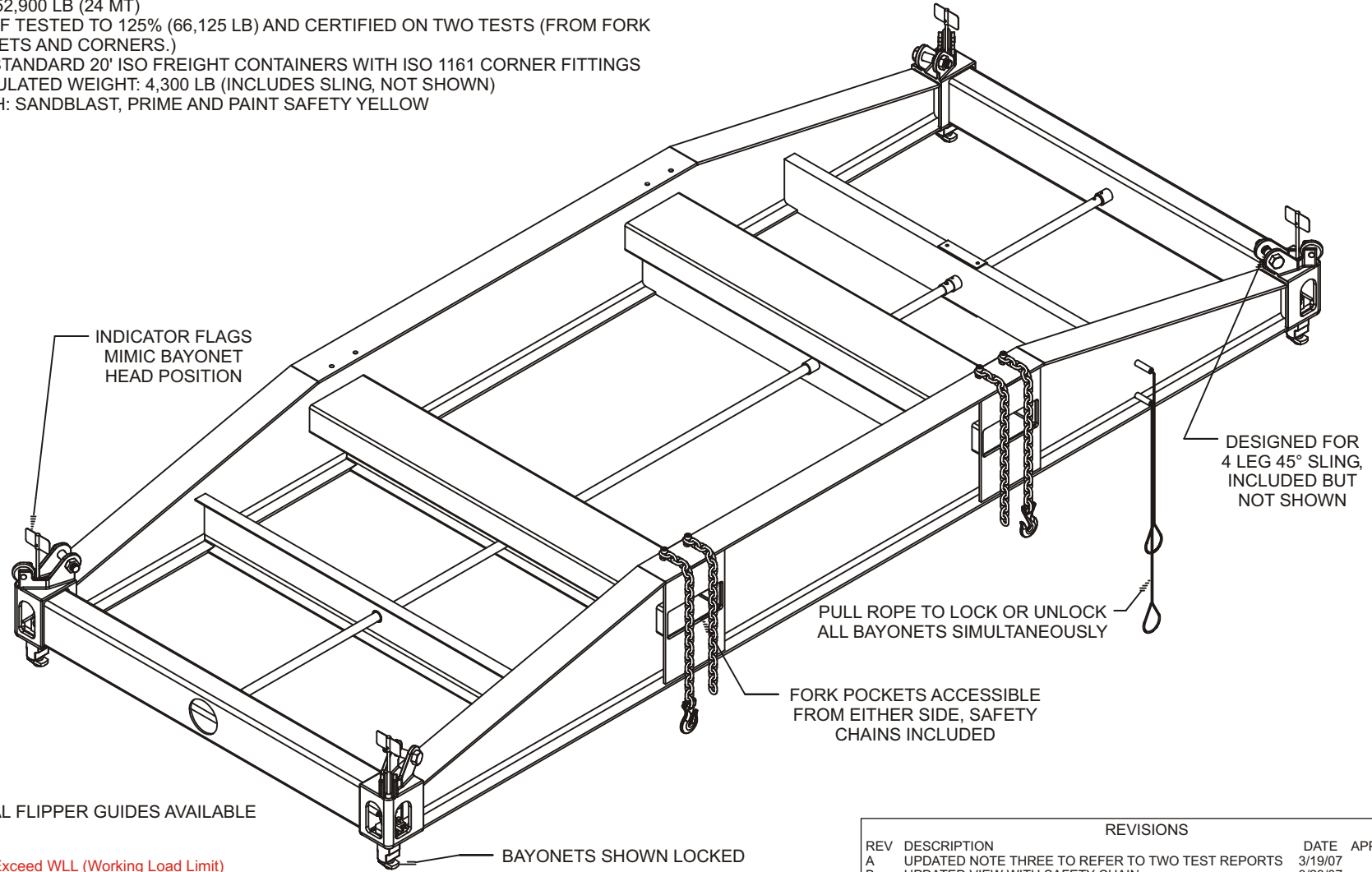

DANGER: Never Exceed WLL (Working Load Limit)
This document contains data which is either patented, patent pending or is the property of Tandemloc, Inc.
Disclosure, or copying without the written authorization of Tandemloc, Inc. is expressly prohibited. © Copyright 2011 by Tandemloc, Inc.
Dimensions are subject to manufacturing tolerance and change.

| | | REVISIONS | |
|-----|---|-----------|----------|
| REV | DESCRIPTION | DATE | APPROVED |
| A | UPDATED NOTE THREE TO REFER TO TWO TEST REPORTS | 3/19/07 | ML |
| B | UPDATED VIEW WITH SAFETY CHAIN | 3/23/07 | ML |
| C | ADDED VINYL LABELS AND CELL GUIDE WHEELS | 4/6/09 | DAH |



Email: info@tandemloc.com • www.tandemloc.com
PO Box 279 • 824 Highway 101 • Havelock, NC 28532-0279
TEL: 1.800.258.7324 (252.447.7155)
FAX: 1.800.892.3273 (252.447.5502)

Tandemloc designs, manufactures and tests lifting, securing and mobilizing components for all industries. See our website for details and important safety information.

Tandemloc is a member of:



20' FORKLIFT SPREADER (AC37000A-1PA)

Cage Code: 65059 | Drawing No: SAC37000A | Revision: C | Sheet: 2 of 3

UNLESS OTHERWISE SPECIFIED, DIMENSIONS ARE IN INCHES
SEE ELECTRONIC PARTS LIST FOR BILL OF MATERIALS

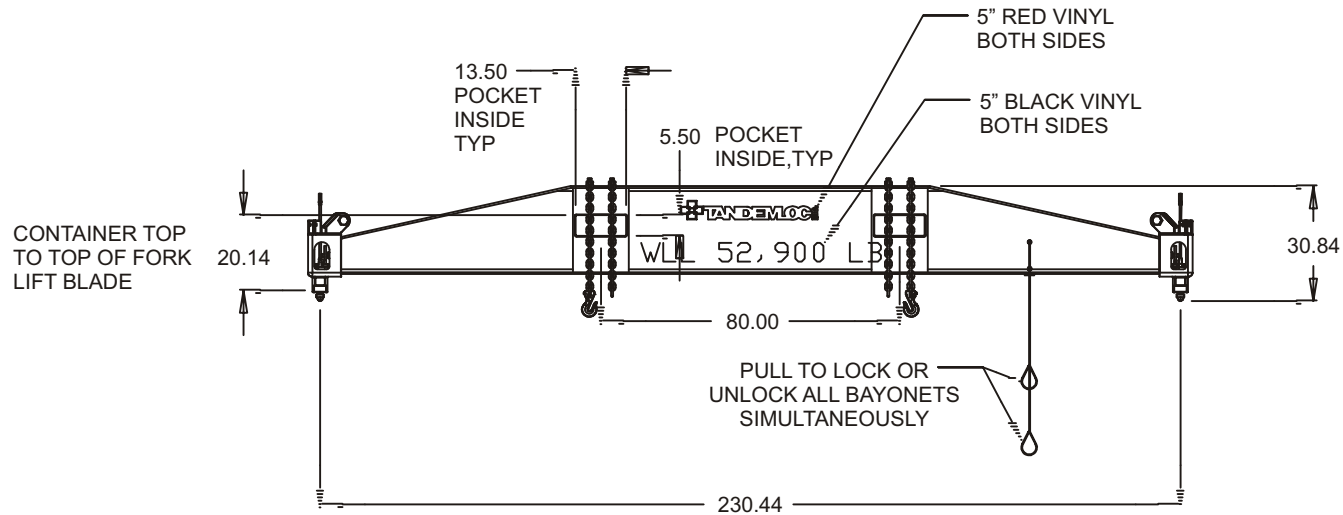
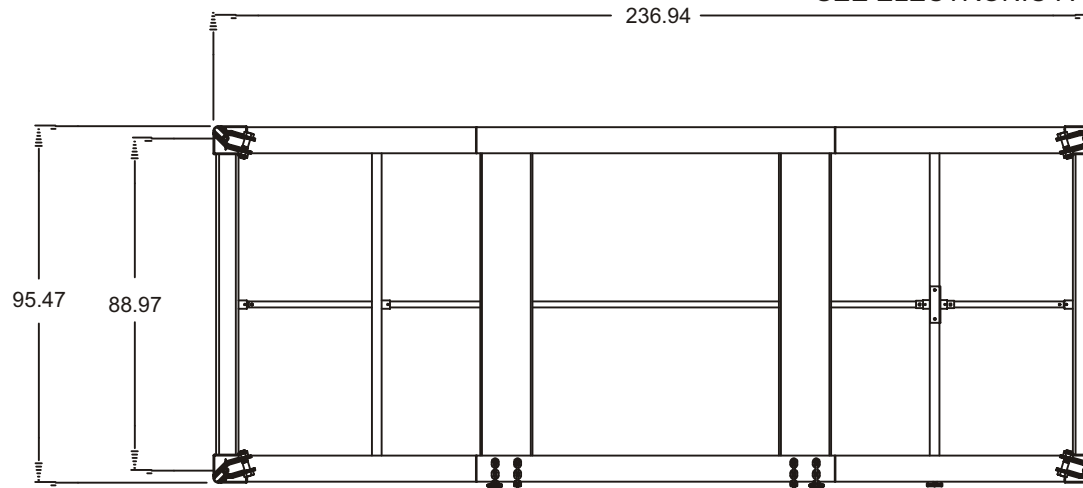

DANGER: Never Exceed WLL (Working Load Limit)
This document contains data which is either patented, patent pending or is the property of Tandemloc, Inc.
Disclosure, or copying without the written authorization of Tandemloc, Inc. is expressly prohibited. © Copyright 2011 by Tandemloc, Inc.
Dimensions are subject to manufacturing tolerance and change.

| REVISIONS | | DATE | APPROVED |
|-----------|---|---------|----------|
| REV | DESCRIPTION | | |
| A | UPDATED NOTE THREE TO REFER TO TWO TEST REPORTS | 3/19/07 | ML |
| B | UPDATED VIEW WITH SAFETY CHAIN | 3/23/07 | ML |
| C | ADDED VINYL LABELS AND CELL GUIDE WHEELS | 4/6/09 | DAH |



Email: info@tandemloc.com • www.tandemloc.com
PO Box 279 • 824 Highway 101 • Havelock, NC 28532-0279
TEL: 1.800.258.7324 (252.447.7155)
FAX: 1.800.892.3273 (252.447.5502)

Tandemloc designs, manufactures and tests lifting, securing and mobilizing components for all industries. See our website for details and important safety information.

Tandemloc is a member of:



NOTES:

1. PART NO.: Q0800AA-2PA, 40' FORKLIFT SPREADER, 20'
2. WLL: 67,200 LB
3. PROOF TESTED TO 125% (84,000 LB) AND CERTIFIED
4. STANDARD SPECIFICATION #EAD21000A APPLIES
5. CALCULATED WEIGHT: 9,000 LB
6. DESIGNED AND MANUFACTURED TO MEET OR EXCEED ASME B30.20

40' FORKLIFT SPREADER (Q0800AA-2PA)

Cage Code: 65059 | Drawing No: Q0800AA-2PA | Revision: -- | Sheet: 3 of 3

UNLESS OTHERWISE SPECIFIED, DIMENSIONS ARE IN INCHES
SEE ELECTRONIC PARTS LIST FOR BILL OF MATERIALS

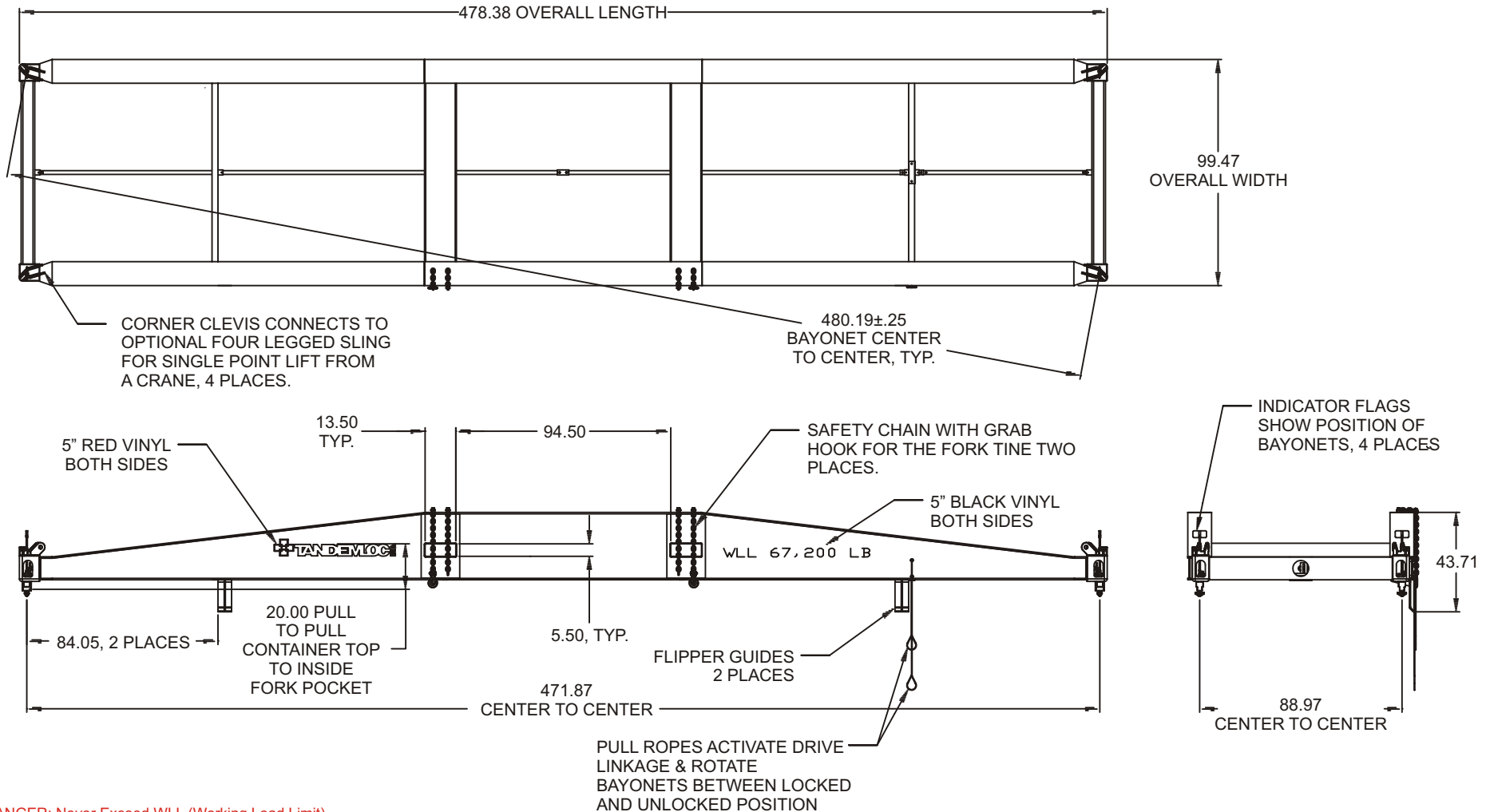

DANGER: Never Exceed WLL (Working Load Limit)

This document contains data which is either patented, patent pending or is the property of Tandemloc, Inc.

Disclosure, or copying without the written authorization of Tandemloc, Inc. is expressly prohibited. © Copyright 2011 by Tandemloc, Inc.

Dimensions are subject to manufacturing tolerance and change.



Email: info@tandemloc.com • www.tandemloc.com
 PO Box 279 • 824 Highway 101 • Havelock, NC 28532-0279
 TEL: 1.800.258.7324 (252.447.7155)
 FAX: 1.800.892.3273 (252.447.5502)

Tandemloc designs, manufactures and tests lifting, securing and mobilizing components for all industries. See our website for details and important safety information.

Tandemloc is a member of:

