

AUTOLOC® SPREADER SANDBOX LIFTER (AE38000A-1PA)

Cage Code: 65059 | Drawing No: SAE38000A | Revision: A | Sheet: 1 of 1

UNLESS OTHERWISE SPECIFIED, DIMENSIONS ARE IN INCHES

REV	DESCRIPTION	REVISIONS	DATE	APPROVED
A	ADDED FLIPPER GUIDES, FURTHER DEFINED TOP SLING ASSEMBLY		01-20-05	MRD

NOTES:

- P/N: AE38000A-1PA, AUTOLOC® SPREADER SANDBOX LIFTER
- WLL: 37.5 TON (75,000 LB)
- PROOF TESTED TO 125% (93,750 LB) AND CERTIFIED
- STANDARD SPECIFICATION #EAD2100A APPLIES
- FINISH: SANDBLAST, THERMAL ZINC, PRIME AND PAINT SAFETY YELLOW
- CALCULATED WEIGHT: FRAME = 1,312 LBS
WIRE ROPE SLING = 200 LBS
TOTAL WEIGHT = 1,512 LBS

- TOP SLING ASSEMBLY
- 2.00 DIA. MASTER RING
 - KWS P/N: F102200A OR EQUAL
 - 1.25 DIA. IWRC 6X19 WIRE ROPE
 - HEAVY DUTY SLEEVE
 - CROSBY P/N: 1041287 OR EQUAL
 - HEAVY DUTY WIRE ROPE THIMBLES
 - CROSBY P/N: 1037835 OR EQUAL

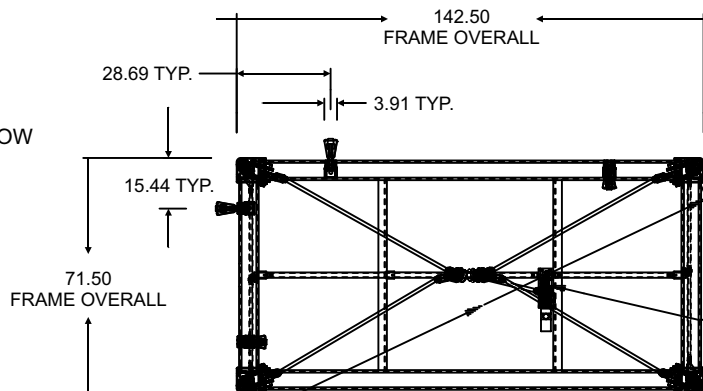

AUTOLOC® GEAR BOX ACTIVATES DRIVE LINKAGE & ROTATES TWISTLOCK BAYONETS. ALTERNATES BETWEEN LOCKED & UNLOCKED EACH TIME THE SLING IS SLACKENED FROM A FULLY TENSIONED POSITION.

150.73±.25 TYP. BOTH DIAGONALS
BAYONET CENTER TO BAYONET CENTER

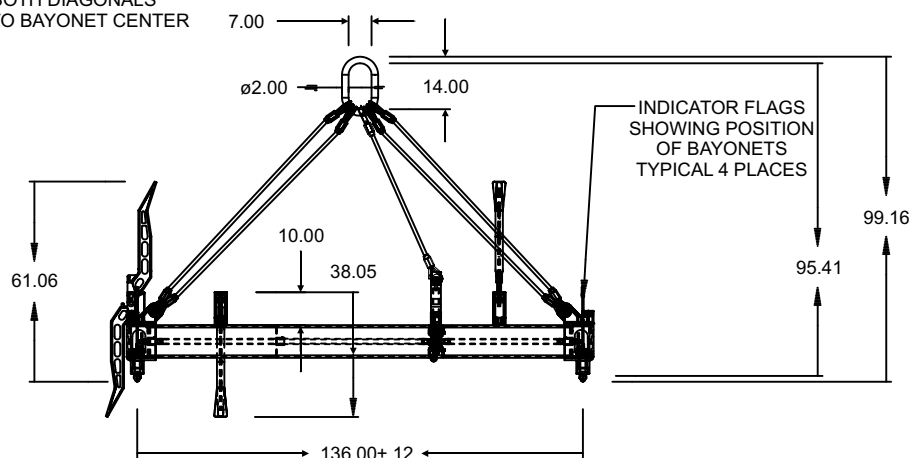
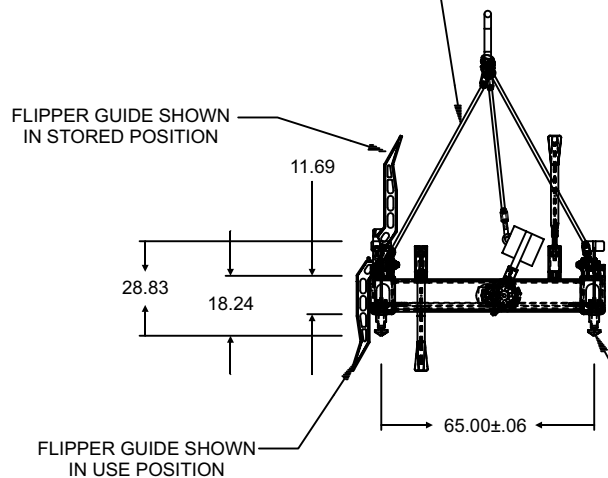

TWISTLOCK BAYONETS 4 PLACES DESIGNED TO FIT IN LARGE HOLE OF ISO 1161 CORNER FITTINGS (SHOWN IN LOCKED POSITION)

To avoid lifter failure, potential death and property damage, never exceed WLL (Working Load Limit)

This document contains the proprietary information of Tandemloc, Inc. and your access and use shall be, and is at all times, pursuant to and limited by the Tandemloc, Inc. Terms of Use.

You shall not, and shall not encourage, assist, or authorize another party to copy, distribute, publically display, modify, reverse engineer, decompile, or take any other action to reproduce or replicate this document or the information contained herein. © Copyright 2012 by Tandemloc, Inc.

Dimensions are subject to manufacturing tolerance and change.



Email: info@tandemloc.com • www.tandemloc.com

824 Highway 101 • Havelock, NC 28532

TEL: 1.800.258.7324 (252.447.7155)

FAX: 1.800.892.3273 (252.447.5502)

Tandemloc designs, manufactures and tests lifting, securing and mobilizing components for all industries. See our website for details and important safety information.

Read all safety labels and instructions prior to use. Product to be used by qualified personnel only.